

# HÉRCULES® PLUS PANEL

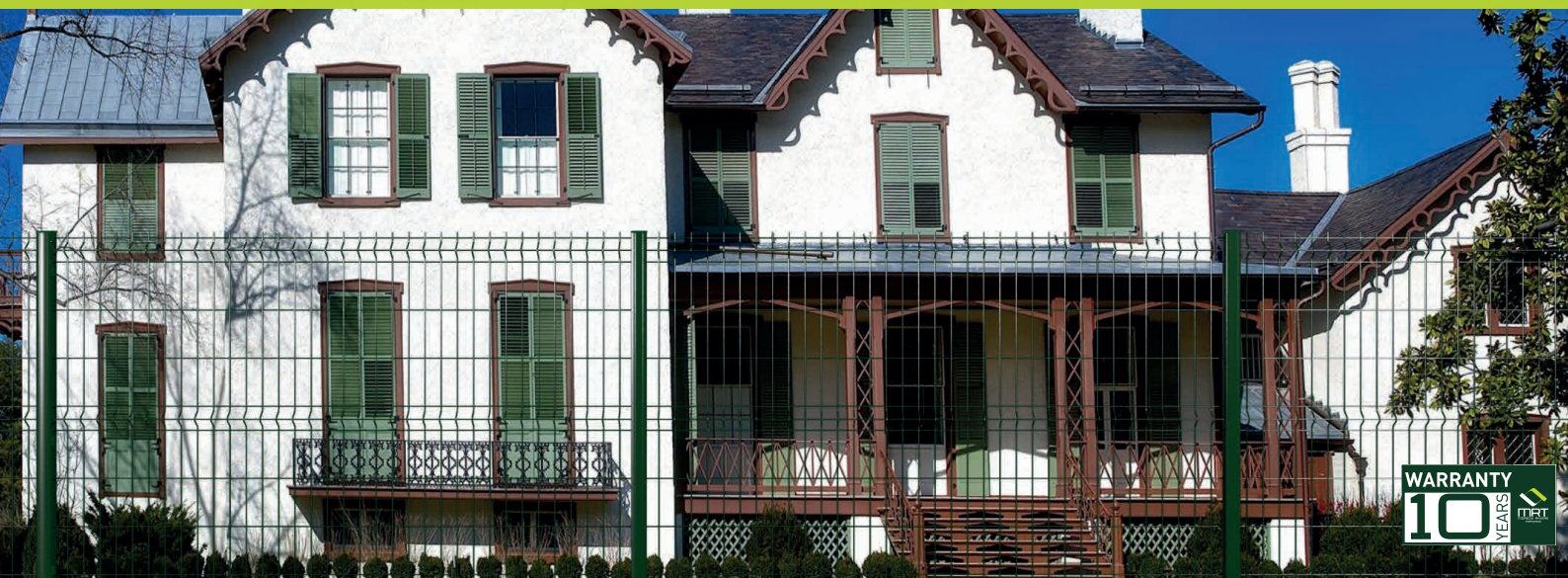

## CHARACTERISTICS

| Plastified wire diameter (mm) | Mesh (mm) | Length (mm) | Height (mm) | Number of bends |
|-------------------------------|-----------|-------------|-------------|-----------------|
| 5.00                          | 200x55    | 2,500       | 625         | 2               |
|                               |           |             | 825         | 2               |
|                               |           |             | 1,025       | 2               |
|                               |           |             | 1,225       | 2               |
|                               |           |             | 1,525       | 3               |
|                               |           |             | 1,725       | 3               |
|                               |           |             | 1,925       | 3               |
|                               |           |             | 2,025       | 4               |
|                               |           |             | 2,225       | 4               |
| 2,425                         | 4         |             |             |                 |

Other dimensions available upon request.

## STANDARD DIMENSIONS

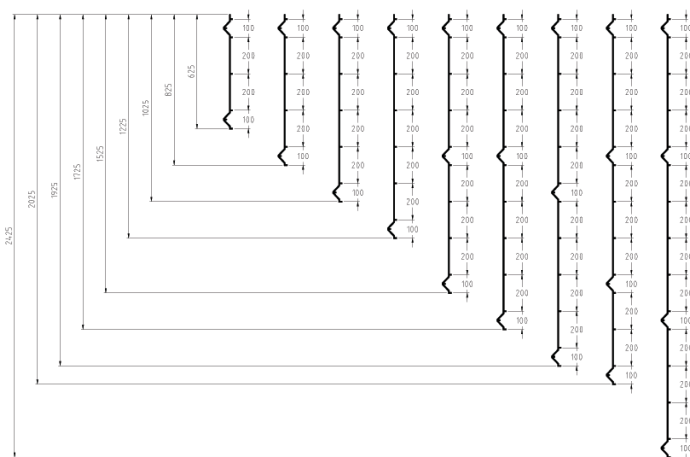

## INSTALLATION

| Post      | Accessory                           | Distance between post axis (mm) |
|-----------|-------------------------------------|---------------------------------|
| Easyclip® | Polyamide / aluminum / inox bracket | 2,520                           |
| Profix®   | -                                   | 2,540                           |
| Hércules® | Hércules® Staple                    | 2,525 (+/-10)                   |
|           | Ultrafix® Bracket                   | 2,525 (+10/-20)                 |
|           | Hércules® Bracket                   | 2,525 (+10/-20)                 |
| Quickfix® | Polyamide / metallic Bracket        | 2,520                           |
|           | Quickfix® Accessory for panels      | 2,550 (+/-10)                   |
| 60x60 MRT | Polyamide Staple                    | 2,530 (+10/-5)                  |

## ASSOCIATED PRODUCTS

### KIT D'OCCULTATION

- Provides privacy to your enclosure with the PVC Hércules® Privacy Kit formed by PVC or Wood sheets.

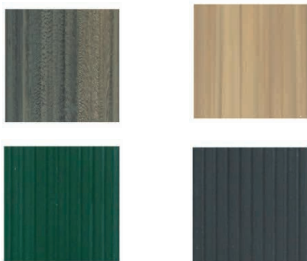

### MRT GATES

- Swing gates, Sliding gates and Cantilever Sliding Gates

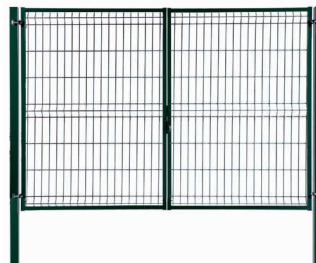

### PANEL ACCESSORY

- Fix the panel directly to the gate post.

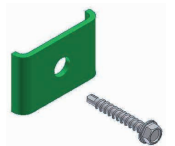

### WALL ACCESSORY

- Fix the panel to a wall without using posts.



## FINISHING FEATURES

### PLASTIFIED

10 Standard RAL colours:

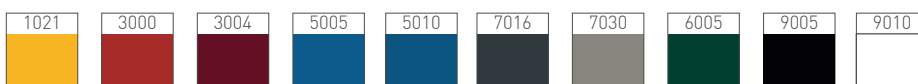

More than 200 RAL colours available



- Hot dip galvanized wire according to EN 10244-2 standards. Welded panel according to EN 10223-7.
- Polyester powder coating by microcrystalline phosphatation: Polyester thickness: 100 microns minimum.