

ECO CUBE



INDEX

1. Data and Documentation
2. Use
3. Specification item

1. DATA AND DOCUMENTATION

Code	Description	Weight	Measurements (m)	Colour	Pkg. / Pallet
TER26-6310	Eco Cubiera	350 g	172 x 172 x 165 mm	Grey	18 pcs. / 144 pcs.

MATERIAL

Made of PP (polypropylene).

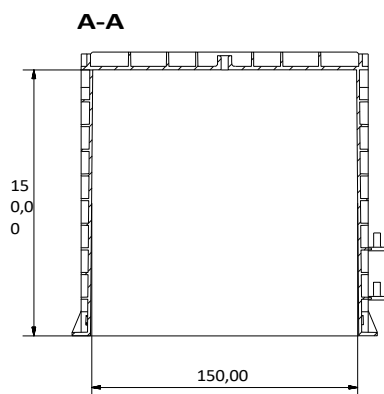
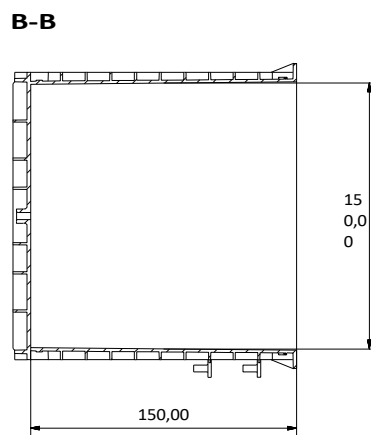
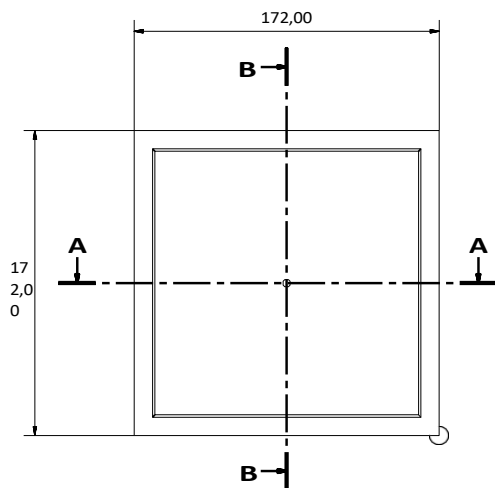

ECO CUBE

2. USE

The use must follow the requirements of UNI EN 12390-1:2002 and its updates.



Once the cube is taken out, detach the cap and insert it into the hole at the bottom.



Fill completely, as specified, with the concrete to be tested.



Wait until the specimen is fully cured for testing (28 days).



To extract the specimen, use a jet of air from the hole previously plugged.



There, the audition is ready!

3. SPECIFICATION ITEMS

Entry	Description	Unit	Price
Dak.E.TER26.6310	Supply and installation of Cubes for making cubes for concrete testing, manufactured in accordance with UNI EN 12390-1:2002 allows the realisation of concrete specimens for simple compression load tests. It is reusable n-times. Made of PP (polypropylene). Bottom with pre-cut hole, the container is filled with concrete and cured (at 28 days). The specimen is removed with a jet of compressed air or, if necessary, by breaking the container along the pre-cut. No lid required	pc.	-